

PERKINS COUNTY SOUTH HALF SOUTH DAKOTA

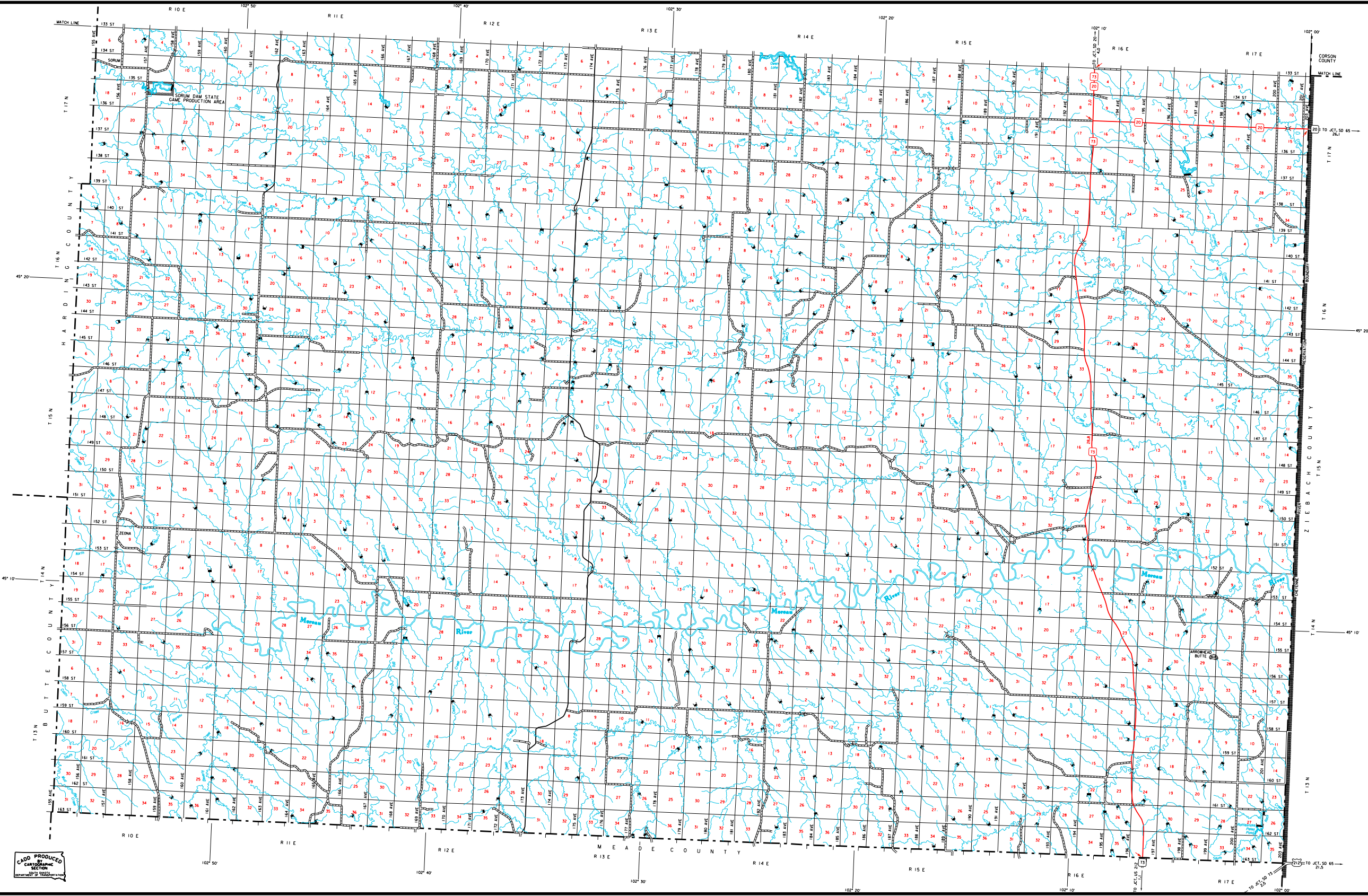

LEGEND

INTERSTATE HIGHWAY - FULL CONTROL OF ACCESS	ROAD BRIDGE OVER 20 FT. IN LENGTH	NARROW STREAM
U.S. NUMBERED HIGHWAY	HIGHWAY BRIDGE CLOSER SPACED	RIDE STREAM - INTERMITTENT NAVIGATION
STATE NUMBERED HIGHWAY	STEEL TRUSS BRIDGE LARGE	DRAINAGE DITCH (MAIN)
FEDERAL AID HIGHWAY SYSTEM	CHALLENGER BRIDGE	IRREGULAR DITCH
FEDERAL AID SECONDARY HIGHWAY SYSTEM	FORD - ROAD ESTABLISHED	RESERVOIR, POND OR LAKE
END OF FEDERAL AID DESIGNATED ROUTE	CONCRETE FORD	RESERVOIR, WITH DAM
PRIMITIVE ROAD	CAULDRY	DAM
UNIMPROVED ROAD	CATTLE GUARD	WASH OR SWAMP LAND
GRAVEL OR STONE SURFACED ROAD	PROMONT ELEVATION	DOCK, PIER, OR LANDING
HARD SURFACED ROAD	STATE LINE	HIGHWAY BRIDGE OVER 20 FT. IN LENGTH
DIVIDED HIGHWAY (WITH CENTERLINE ROAD)	COUNTY LINE	STEEL TRUSS BRIDGE LARGE
INTERCHANGE	CONGRESSIONAL TOWNSHIP LINE	CHALLENGER BRIDGE
HIGHWAY GRADE SEPARATION	SECTION LINE	FORD - ROAD ESTABLISHED
POINTS BETWEEN WHICH DISTANCES ARE MEASURED INDICATED THUS	FEDERAL AND STATE RESERVATION BOUNDARY LINE	CONCRETE FORD
RAILROAD	MONUMENT (SMALL)	CAULDRY
RAILROADS IN JUNCTATION	COUNTY SEAT	CATTLE GUARD
TWO OR MORE TRACES OF SEPARATELY OPERATED COMPANIES OR ADJACENT RIGHT-OF-WAY	OTHER CITIES AND VILLAGES	PROMONT ELEVATION
RAILROAD CROSSING	UNINCORPORATED VILLAGE OR AREA OF CONCENTRATED CULTURE	STATE LINE
RAILROAD ABOVE	INCORPORATED CITY OR VILLAGE (FIGURES INDICATED POPULATION)	COUNTY LINE
RAILROAD BELOW		CONGRESSIONAL TOWNSHIP LINE
AIRPORT WITH SURFACED RUNWAYS		SECTION LINE
		FEDERAL AND STATE RESERVATION BOUNDARY LINE
		MONUMENT (SMALL)
		COUNTY SEAT
		OTHER CITIES AND VILLAGES
		UNINCORPORATED VILLAGE OR AREA OF CONCENTRATED CULTURE
		INCORPORATED CITY OR VILLAGE (FIGURES INDICATED POPULATION)



GENERAL HIGHWAY MAP
SOUTH HALF
PERKINS COUNTY
SOUTH DAKOTA

prepared by the
SOUTH DAKOTA DEPARTMENT OF TRANSPORTATION
in cooperation with the
U.S. DEPARTMENT OF TRANSPORTATION
FEDERAL HIGHWAY ADMINISTRATION

SCALE
0 2 4 5 MILES
2021



UNIVERSAL TRANSVERSE MERCATOR PROJECTION

CADD PRODUCED BY
CARTOGRAPHIC SECTION

RESTRICTION OF LIABILITY: The South Dakota Department of Transportation makes no claims, promises or warranties about the accuracy, completeness or timeliness of the data and/or maps contained here. We warrant only that the data conforms to the specifications of the data content. We warrant only that the maps, whether or not they are printed, are based on the most current data available to us at the time of their production. The merchantability and fitness for a particular purpose is given with respect to this data.

COPIES OF THIS MAP ARE AVAILABLE FOR PUBLIC USE AT A NOMINAL COST
S.D. Department of Transportation
Map Sale - PL-805-173 5249
Pierre, South Dakota 57501

PERKINS COUNTY SOUTH HALF SOUTH DAKOTA