

**LEGEND**

INTERSTATE HIGHWAY (FULL CONTROL OF ACCESS)		NARROW STREAM	
U.S. NUMBERED HIGHWAY		WIDE STREAM (INVERTMENT NAVIGATION)	
STATE NUMBERED HIGHWAY		DRAINAGE DITCH (NAME)	
FEDERAL AID HIGHWAY SYSTEM		IRRIGATION DITCH	
FEDERAL AND SECONDARY HIGHWAY SYSTEM		RESERVOIR, POND OR LAKE	
END OF FEDERAL AID SEPARATELY ROUTE		RESERVOIR, WIND DAM	
		DAM	
		MARSH OR SWAMP LAND	
PRIMITIVE ROAD		DOCK, PIER, OR LANDING	
UNIMPROVED ROAD		HIGHWAY GRADE (OVER 20 FT. IN LENGTH)	
GRAVEL OR STONE SURFACED ROAD		HIGHWAY BRIDGE (CLOSELY SPACED)	
ROAD SURFACED ROAD		STEEL TRUSS BRIDGE LARGE	
DIVIDED HIGHWAY (WITH CENTER ISLAND)		CANTILEVER BRIDGE	
INTERCHANGE		FORD - ROAD ESTABLISHED	
HIGHWAY GRADE SEPARATION		CONCRETE FORD	
POINTS BETWEEN WHICH DISTANCES ARE MEASURED INDICATED THERE		CAUSEWAY	
RAILROAD IN FULL OPERATION		PROMINENT ELEVATION	
150 OR MORE TRACKS OF SEPARATELY OPERATED COMPANIES ON ADJACENT RIGHT-OF-WAY		STATE LINE	
RAILROAD CROSSINGS		COUNTY LINE	
GRADE CROSSINGS		CONGRESSIONAL TOWNSHIP LINE	
RAILROAD ABANDONED		SECTION LINE	
RAILROAD BELOW		FEDERAL AND STATE RESERVATION BOUNDARY LINE	
AIRPORT WITH SURFACED RUNWAYS		COUNTY SEAT	
		OTHER CITIES AND VILLAGES	
		UNINCORPORATED VILLAGE OR AREA OF CONGESTED CULTURE	
		INCORPORATED CITY OR VILLAGE (FIGURES INDICATE 1990 POPULATION)	
MILITARY FIELD			
ARMORY, COMPLETE FACILITIES (COMMERCIAL OR MUNICIPAL)			
ARMORY, LIMITED FACILITIES			
LANDING AREA OR STRIP (INCLUDING PRIVATE AIR FIELDS)			
AIRWAY LIGHT REGION (GENERAL)			

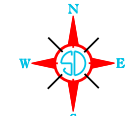
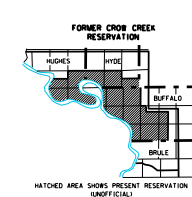

GENERAL HIGHWAY MAP  
**HAND COUNTY**  
 SOUTH DAKOTA

prepared by the  
 SOUTH DAKOTA DEPARTMENT OF TRANSPORTATION  
 in cooperation with the  
 U.S. DEPARTMENT OF TRANSPORTATION  
 FEDERAL HIGHWAY ADMINISTRATION

SCALE  
 0 1 2 3 4 5 MILES

2019

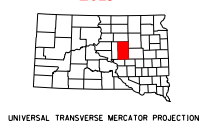

UNIVERSAL TRANSVERSE MERCATOR PROJECTION

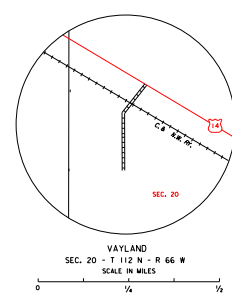
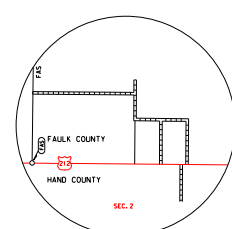

RESTRICTION OF LIABILITY: The South Dakota Department of Transportation makes no claim, guarantee, or warranty of any kind, and assumes no liability for errors and omissions of the data contained herein. The user of this map assumes all responsibility for any and all uses of the data, and the Department of Transportation is not responsible for any and all uses of the data. The Department of Transportation is not responsible for any and all uses of the data. The Department of Transportation is not responsible for any and all uses of the data.

COPIES OF THIS MAP ARE AVAILABLE FOR PUBLIC USE AT A NOMINAL COST  
 S. D. Department of Transportation  
 Map Sales - PL 605/773 3249  
 Pierre, South Dakota 57502