

CITY MAP
CANTON
LINCOLN COUNTY - SOUTH DAKOTA
T 98 N - R 49 W

SCALE
1" = 200ft.
REVISIONS
2017
PREPARED BY
SOUTH DAKOTA
DEPARTMENT OF TRANSPORTATION
IN COOPERATION WITH
U.S. DEPARTMENT OF TRANSPORTATION
FEDERAL HIGHWAY ADMINISTRATION
ALL STREET MILES OF 66' OR 55' FT.
ELEVATE TO FT.
UNLESS OTHERWISE INDICATED
SURVEYED BY

LEGEND	
U.S. NUMBERED HIGHWAY	
STATE NUMBERED HIGHWAY	
STREET, CREEK AND OTHER WATERWAYS	
CURBS, LATERALS, BRIMSTONE STONES WITH DIRECTION OF FLOW	
ROAD SURFACE	
GRAVEL SURFACE	
EARTH SURFACE	
UNIMPROVED	
TRAIL	
RAILROAD	
DRINK ELEVATOR	
TRAINING POOL	
BALL FIELD	
CEMETERY	
HOSPITAL	
HIGHWAY GARAGE (C-COUNTY, S-STATE)	
POST OFFICE	
CHURCH	
LIBRARY	
POWER PLANT	
WATER SUPPLY STAND PIPE OR TANK	
INDUSTRIAL BUILDING	
BLACK PLANT	
FIREHALL	
SCHOOLHOUSE	
TOWNHALL	
MOUSE	
POLICE STATION	
AIRPORT	

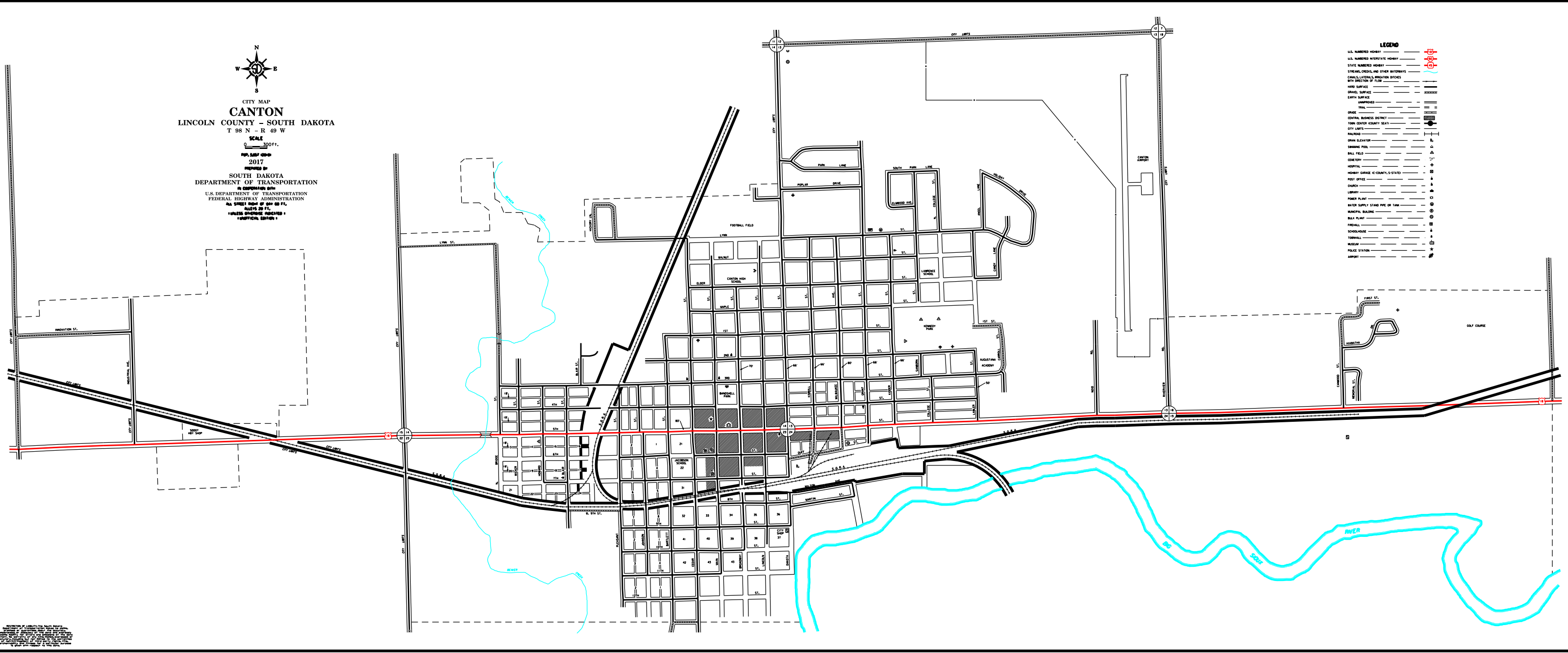

UNLESS OTHERWISE INDICATED, ALL DISTANCES ARE IN FEET. ALL ELEVATIONS ARE IN FEET. ALL SURVEYS WERE MADE BY THE SOUTH DAKOTA DEPARTMENT OF TRANSPORTATION. THE SOUTH DAKOTA DEPARTMENT OF TRANSPORTATION IS NOT RESPONSIBLE FOR ANY DAMAGE TO PERSONS OR PROPERTY THAT MAY BE CAUSED BY THE USE OF THIS MAP. THE SOUTH DAKOTA DEPARTMENT OF TRANSPORTATION IS NOT RESPONSIBLE FOR ANY DAMAGE TO PERSONS OR PROPERTY THAT MAY BE CAUSED BY THE USE OF THIS MAP.