

CITY MAP
BERESFORD
LINCOLN AND UNION
COUNTIES - SOUTH DAKOTA
T 95 - 96 N - R 50 W

SCALE
0 300ft.

POP. 2,005 (2010)
2017
PREPARED BY
SOUTH DAKOTA
DEPARTMENT OF TRANSPORTATION
IN COOPERATION WITH
U.S. DEPARTMENT OF TRANSPORTATION
FEDERAL HIGHWAY ADMINISTRATION
ALL STREET WIDTHS OF 66 FT.
ALLEYS 20 FT.
(UNLESS OTHERWISE INDICATED)
(UNOFFICIAL EDITION)

LEGEND

- U.S. NUMBERED HIGHWAY
- U.S. NUMBERED INTERSTATE HIGHWAY
- STATE NUMBERED HIGHWAY
- STREAMS, CREEKS, AND OTHER WATERWAYS
- CANALS, LATERALS, IRRIGATION DITCHES WITH DIRECTION OF FLOW
- HARD SURFACE
- GRAVEL SURFACE
- EARTH SURFACE
- UNIMPROVED
- TRAIL
- GRADE
- CENTRAL BUSINESS DISTRICT
- TOWN CENTER (COUNTY SEAT)
- CITY LIMITS
- RAILROAD
- GRAN ELEVATOR
- SWIMMING POOL
- BALL FIELD
- CEMETERY
- HOSPITAL
- HIGHWAY GARAGE (IC-COUNTY, S-STATE)
- POST OFFICE
- CHURCH
- LIBRARY
- POWER PLANT
- WATER SUPPLY STAND PIPE OR TANK
- MUNICIPAL BUILDING
- BULK PLANT
- FIREHALL
- SCHOOLHOUSE
- TOWNHALL
- MUSEUM
- POLICE STATION
- AIRPORT

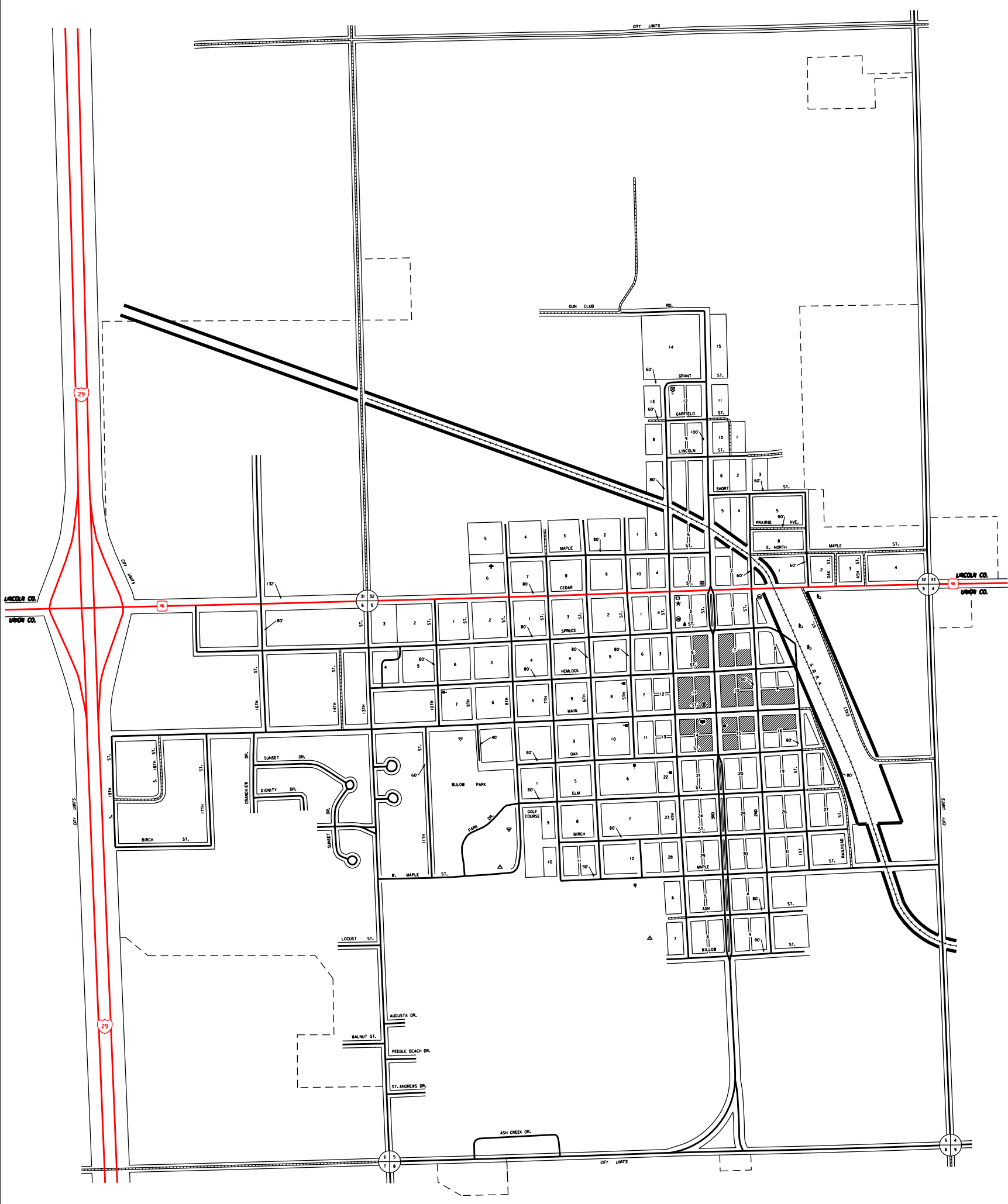

RESTRICTIONS OF LIABILITY: THE SOUTH DAKOTA DEPARTMENT OF TRANSPORTATION AND THE FEDERAL HIGHWAY ADMINISTRATION MAKE NO WARRANTY, REPRESENTATION OR GUARANTEE THAT THIS MAP OR ANY INFORMATION CONTAINED HEREIN IS ACCURATE, COMPLETE, UP-TO-DATE OR FREE FROM ERRORS. THE USER OF THIS MAP ASSUMES ALL LIABILITY FOR ANY DAMAGE OR LOSS OF ANY KIND, INCLUDING REASONABLE ATTORNEY'S FEES, ARISING FROM THE USE OF THIS MAP. THE SOUTH DAKOTA DEPARTMENT OF TRANSPORTATION AND THE FEDERAL HIGHWAY ADMINISTRATION SHALL NOT BE LIABLE FOR ANY DAMAGE OR LOSS OF ANY KIND, INCLUDING REASONABLE ATTORNEY'S FEES, ARISING FROM THE USE OF THIS MAP.