

32° N  
SOUTH DAKOTA  
HARDING COUNTY  
NORTH HALF  
GENERAL HIGHWAY MAP

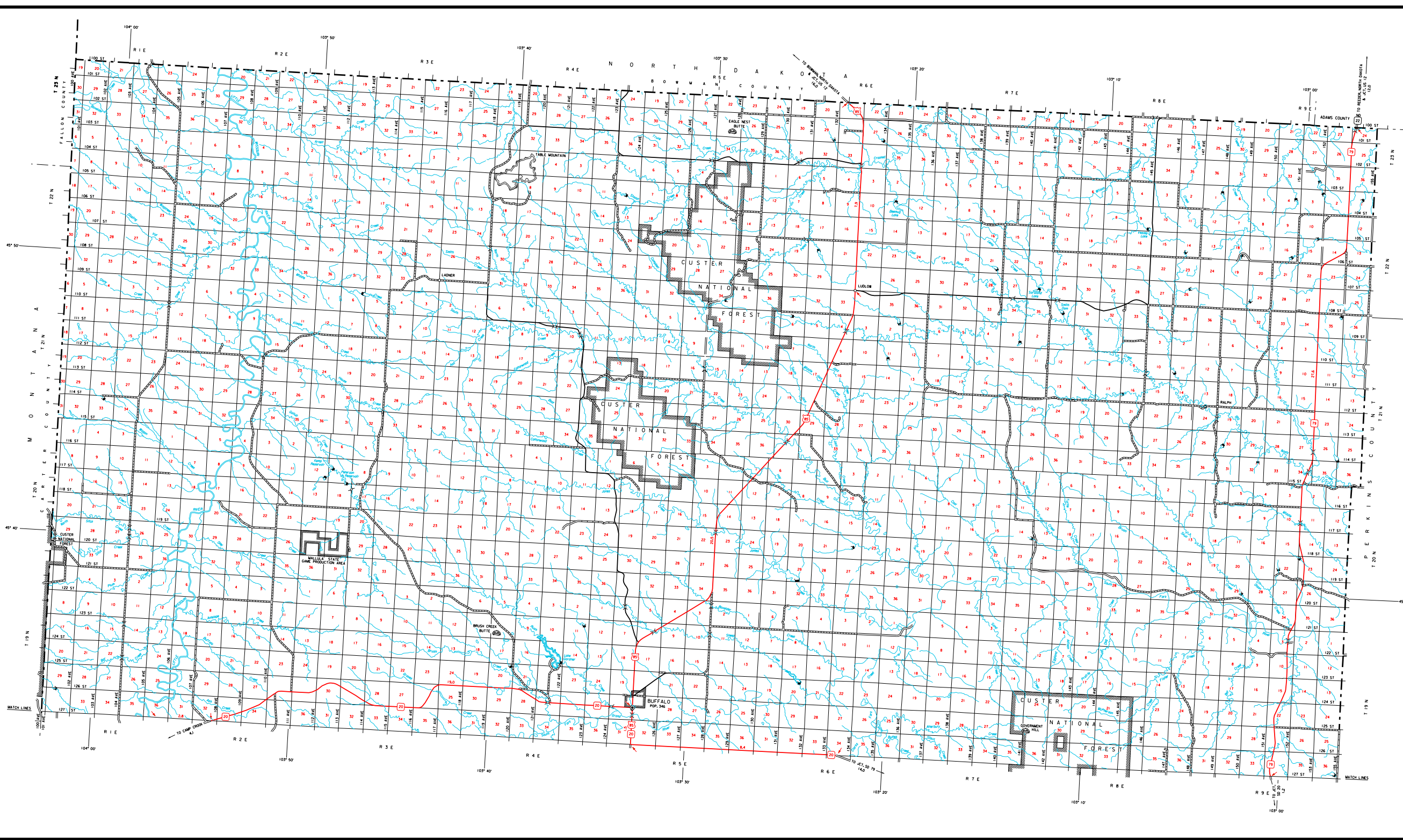

LEGEND	
INTERSTATE HIGHWAY FULL CONTROL OF ACCESS 1	ROAD WITH TRAFFIC SIGNALS
U.S. NUMBERED HIGHWAY	ROAD WITH STOP SIGN
STATE NUMBERED HIGHWAY	ROAD WITH STOP SIGN
FEDERAL AID HIGHWAY SYSTEM	ROAD WITH STOP SIGN
FEDERAL AID SECONDARY HIGHWAY SYSTEM	ROAD WITH STOP SIGN
END OF FEDERAL AID DESIGNATED ROUTE	ROAD WITH STOP SIGN
PRIMITIVE ROAD	ROAD WITH STOP SIGN
IMPROVED ROAD	ROAD WITH STOP SIGN
GRAVEL AND GRAVEL ROAD	ROAD WITH STOP SIGN
HARD SURFACED ROAD	ROAD WITH STOP SIGN
GRAVEL HIGHWAY WITH FENCE	ROAD WITH STOP SIGN
INTERSECTIONS	ROAD WITH STOP SIGN
HIGHWAY GRADE SEPARATION	ROAD WITH STOP SIGN
POINTS BETWEEN WHICH DISTANCES ARE MEASURED	ROAD WITH STOP SIGN
RAILROAD	ROAD WITH STOP SIGN
RAILROAD CROSSINGS	ROAD WITH STOP SIGN
RAILROAD ABOVE	ROAD WITH STOP SIGN
RAILROAD BELOW	ROAD WITH STOP SIGN
RAILROAD WITH SURFACED RUMBLE	ROAD WITH STOP SIGN
MILITARY FIELD	ROAD WITH STOP SIGN
AIRPORT, COMPLETE FACILITIES	ROAD WITH STOP SIGN
COMMERCIAL OR MUNICIPAL	ROAD WITH STOP SIGN
AIRFIELD, LIMITED FACILITIES	ROAD WITH STOP SIGN
ARMED AREA OR STAY	ROAD WITH STOP SIGN
INCLUDING PRIVATE AIR FIELDS	ROAD WITH STOP SIGN
ARMY LIGHT BEACON (GENERAL)	ROAD WITH STOP SIGN
NARROW STREAM	ROAD WITH STOP SIGN
WIDE STREAM (UNIMPROVED NAVIGATION)	ROAD WITH STOP SIGN
SHRIMP DITCH (LAW)	ROAD WITH STOP SIGN
IRRIGATION DITCH	ROAD WITH STOP SIGN
FENCE	ROAD WITH STOP SIGN
RESERVOIR, WITH DAM	ROAD WITH STOP SIGN
DAM	ROAD WITH STOP SIGN
WASH OR SWAMP LAND	ROAD WITH STOP SIGN
DOCK, PIER, OR LANDING	ROAD WITH STOP SIGN
HIGHWAY BRIDGE (OVER 20 FT. H. LENGTH)	ROAD WITH STOP SIGN
HIGHWAY BRIDGES CLOSELY SPACED	ROAD WITH STOP SIGN
STEEL TRUSS BRIDGE LAKE	ROAD WITH STOP SIGN
CONCRETE BRIDGE	ROAD WITH STOP SIGN
FORD - ROAD ESTABLISHED	ROAD WITH STOP SIGN
CONCRETE FORD	ROAD WITH STOP SIGN
CROSSWAY	ROAD WITH STOP SIGN
CATTLE GUARD	ROAD WITH STOP SIGN
PERMANENT ELEVATION	ROAD WITH STOP SIGN
STATE LINE	ROAD WITH STOP SIGN
COUNTY LINE	ROAD WITH STOP SIGN
CONGRESSIONAL TOWNSHIP LINE	ROAD WITH STOP SIGN
SECTION LINE	ROAD WITH STOP SIGN
FEDERAL AND STATE RESERVATION BOUNDARY LINE	ROAD WITH STOP SIGN
MONUMENT (SMALL)	ROAD WITH STOP SIGN
COUNTY SEAT	ROAD WITH STOP SIGN
OTHER CITIES AND VILLAGES	ROAD WITH STOP SIGN
UNINCORPORATED VILLAGE OR AREA OF CONGESTED OUTLAYS	ROAD WITH STOP SIGN
INCORPORATED CITY OR VILLAGE	ROAD WITH STOP SIGN
FIGURES INDICATE 1990 POPULATION	ROAD WITH STOP SIGN

N  
W E S

**GENERAL HIGHWAY MAP**  
NORTH HALF  
**HARDING COUNTY**  
SOUTH DAKOTA

prepared by the  
**SOUTH DAKOTA DEPARTMENT OF TRANSPORTATION**  
in cooperation with the  
**U.S. DEPARTMENT OF TRANSPORTATION**  
FEDERAL HIGHWAY ADMINISTRATION

SCALE  
0 2 4 6 MILES

**2021**

UNIVERSAL TRANSVERSE MERCATOR PROJECTION

RESTRICTION OF LIABILITY: The South Dakota Department of Transportation makes no claim, promise or warranty of any kind, and assumes no liability for errors and omissions of the data contained in this map. It is the user's responsibility to verify the accuracy of the data for their own purposes. The Department of Transportation and its employees shall not be held liable for any damages or losses resulting from the use of this map. The Department of Transportation shall not be held liable for any damages or losses resulting from the use of this map.

32° N  
SOUTH DAKOTA  
HARDING COUNTY  
NORTH HALF  
GENERAL HIGHWAY MAP