

Public Meeting

SD Highway 46
From US81 to Irene
Yankton County

P-PH 0046(66)334 PCN 04X4

Darin Johnson
Road Design Engineer

October 29, 2018



Purpose of the Meeting

- **Involve the public in the planning and design process**
- **Provide a project overview**
 - Background information
 - Proposed project
 - Project schedule
- **Gather input and comments**



Project Limits

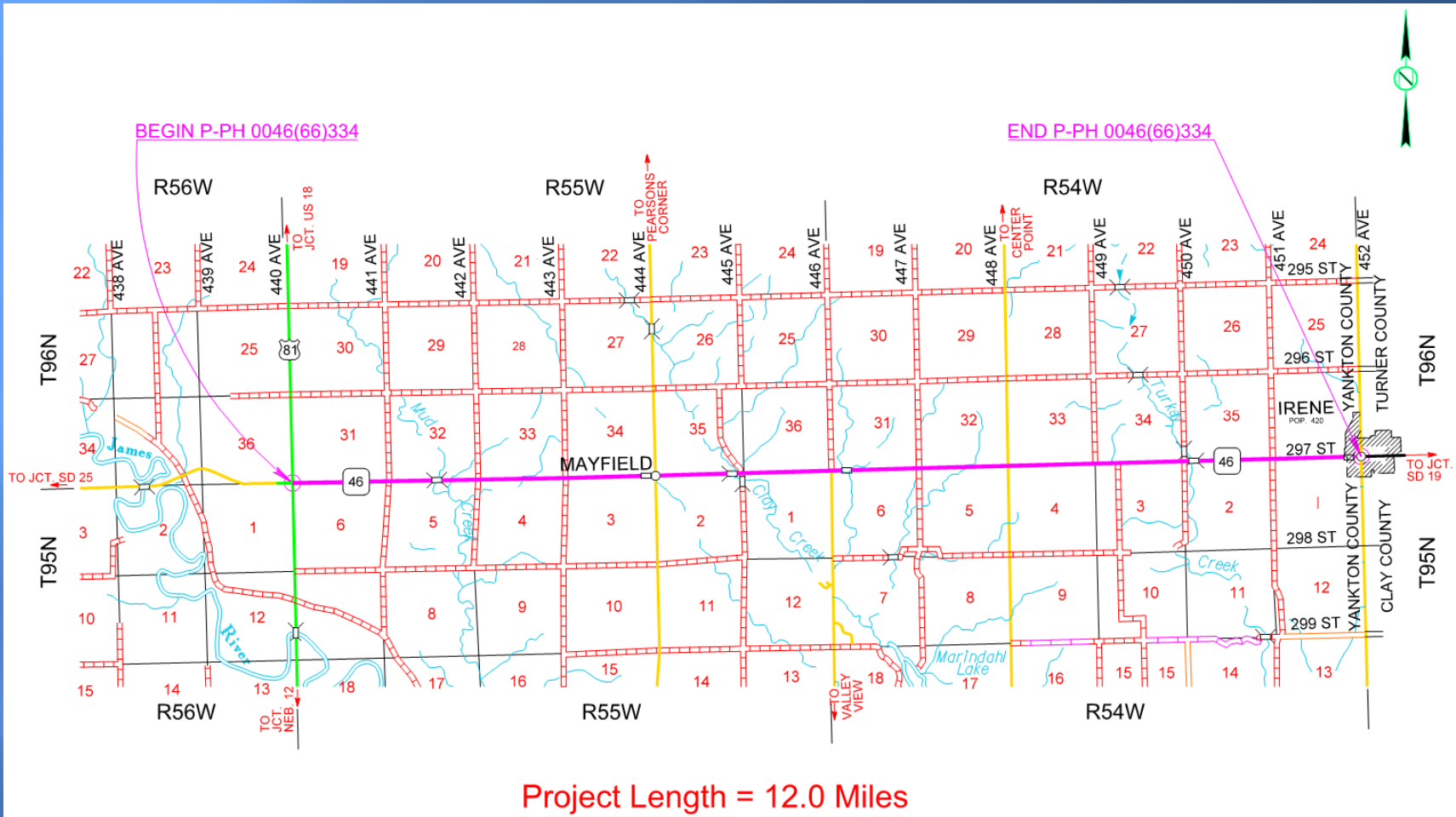

Background Information

- **Grading & Structures in 1953**
- **Resurfaced in 2010**
- **Asphalt Crack Seal in 2011**
- **Chip Seal in 2012**



Traffic

- **2016 Average Daily Traffic (ADT) = 2159**
- **2041 Projected ADT = 3130**
- **13.2% Average Truck Traffic**

Crash History

➤ 5 Year Period from 2013 to 2017

- 37 Reported Crashes
 - 1 Fatal Crash (2 Fatalities)
 - 6 Injury
 - 18 Animal Hits
- Weighted Crash Rate = 1.22

➤ Rural Minor Arterial

- Statewide Weighted Crash Rate = 1.74
crashes per million vehicle miles of travel



Highway Deficiencies

- Vertical Grades / Curves
- Narrow Shoulders – 4 feet



Bridges

- Current bridge locations - Clay Creek & Turkey Creek
- Nearing end of service life



Proposed Improvements

- **Widen Roadway – 8 ft. Shoulders**
- **Improve Vertical Grades / Curves**
 - **Improve Sight Distance and Expand Passing Opportunities**
- **Replace Bridges and Reinforced Concrete Box Culverts**
- **Replace Fence and Culverts**
- **Asphalt Concrete Surfacing (Final Surfacing 2023)**
- **Lighting at US81 / SD46 Intersection**



Proposed Typical Section

SD HIGHWAY 46 TYPICAL GRADING SECTION

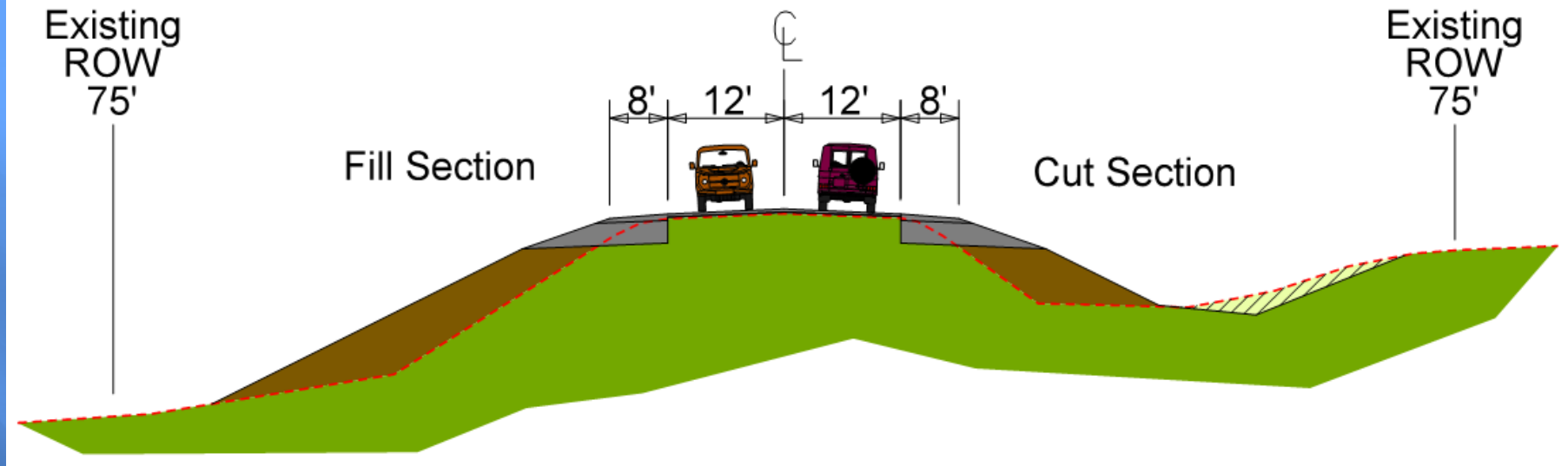

Horizontal Alignment

- Centered on existing highway right-of-way – US81 to 451st Ave. (11 Miles)
- Beginning at 451st Ave., shifted to the south to avoid impacts to cemetery
 - 18' shift at cemetery
- Match with existing alignment 300' west of Till Ave.

See Handout



Vertical Alignment

- **444th Ave. (Mayfield) to Irene – significant proposed grade change**
 - **12' cut (grade lowering) at hill east of Clay Creek**
 - **18' fill (grade raise) in valley at Turkey Creek**
 - **All proposed vertical grades to be 4% or less (except at Irene)**
 - **5% proposed vertical grade immediately west of Irene**

See Handout



Borrow / Waste

- **Borrow (additional) material needed at the following locations:**
 - **West end of project near US81**
 - **Mud Creek**
 - **Turkey Creek**
- **Waste (excess) material at the following location:**
 - **Clay Creek**
- **Contact Keith Long – Mitchell Region Materials Engineer (605) 995-3320**

See Handout



Intersecting Roads

- Due to proposed vertical grade changes along SD46, portions of the following intersecting roads will require reconstruction:
 - 445th Ave. (7 Miles W. of Irene)
 - 448th Ave. (4 Miles W. of Irene)
 - 449th Ave. - North (3 Miles W. of Irene)
 - 450th Ave. (2 Miles W. of Irene)
 - 451st Ave. (1 Mile W. of Irene)

See Handout



Left Turn Lanes

- Left turn lanes are proposed for SD46 at the following intersecting roads:
 - 444th Ave. (8 Miles W. of Irene)
 - 446th Ave. (6 Miles W. of Irene)
 - 448th Ave. (4 Miles W. of Irene)

See Handout



Access Management

- To provide safe, efficient access to streets and highways
- Limit number of direct accesses to major roadways
 - Relocate to section line roads
 - Combine entrances in close proximity to each other
 - Share 40' entrances at property lines

See Handout



Right of Way (ROW)

- Existing width - 150 feet (+/-)
- Purchase additional ROW
 - Locations with high fill / embankment that extend beyond 75'
 - Locations with high cut / excavation that extend beyond 75' (landowner option)
 - Alignment shift at east end of project to provide 65' width on north side at cemetery near Irene
- Temporary easements as needed for construction

See Handout



Encroachments

- **Encroachments - Private Property Located Within the Public ROW**
 - Federal Highway Regulations
 - Safety
- **Examples of Encroachments**
 - Signs
 - Private Use (Parking)
 - Landscaping Items
- **Owners of Encroachments have been Notified by the Yankton Area Office**

See Handout



Utility Coordination

- **Some utilities will need to be relocated**
- **Utility companies may negotiate easements with landowners as needed**

Bon Homme
Yankton Electric
Midcontinent Communications
Vast Broadband
City of Irene

Southeastern Electric
B-Y Rural Water
SDN Communications
Century Link

See Handout



Utility Coordination

➤ Any Known Private Utilities?

- Waterlines
- Drainfields
- Septic Tanks
- Underground Storage Tanks
- Underground Power Lines

➤ Contact SDDOT

See Handout



Environmental, Social & Economic Concerns

The National Environmental Policy Act of 1969 (NEPA) requires that federally funded projects be reviewed to determine the social, economic, and environmental consequences of the action. Public involvement is beneficial to the implementation of a project's NEPA process. This project is being developed in accordance with applicable State & Federal environmental regulations. **Your input** on the following will aid in the project's development and NEPA review.

Section 4(f) Property

The project was reviewed to determine potential impacts to Section 4(f) properties, i.e. publicly owned parks, recreational areas, wildlife & waterfowl refuges, or public & private historical sites. **No Section 4(f) properties have been identified along the project.**

Contaminated Materials

No contaminated materials have been identified along the project, to date. If you have information on contaminated materials, or underground/above ground storage tanks that could be encountered during construction, please let us know.

See Handout



Environmental, Social & Economic Concerns

Section 106

Section 106 of the National Historic Preservation Act requires Federal actions to take into account the effects of project undertakings on historic properties.

A cultural resources survey will be conducted on the project to determine if historic / archaeological resources will be impacted by the project.

Wetlands

Federal regulations require that unavoidable wetland impacts caused by highway construction be mitigated. **Wetland impacts have not been determined yet for this project.** If you are interested in creating or restoring wetlands on your property, please complete the Wetland Mitigation Registry Form in the handouts.

See Handout



Environmental, Social & Economic Concerns

Threatened & Endangered Species

The U.S. Fish & Wildlife Service will review the project to determine if it will impact the following species that are known to occur in Yankton County:

- Birds: Least Tern, Piping Plover, Whooping Crane, Red Knot
- Mammals: Northern Long-eared Bat
- Fish: Pallid Sturgeon, Topeka Shiners
- Clams: Higgins Eye, Scaleshell Mussel
- Plants: Western Prairie-Fringed Orchid

Awaiting a final determination but at this time no impacts are anticipated to these species by the project.

See Handout



Construction Traffic Control

- Road will be closed to through traffic during construction
- Local traffic and emergency vehicle access will be maintained



Construction Traffic Control

- Detour route for Highway SD 46 traffic during construction



Landowner Meetings

➤ Early 2019

- Will be contacted by SDDOT to schedule appointment

➤ Held with individual landowners adjacent to the project

- Driveway location / widths
- Fence
- Drainage
- Trees
- Temporary easements or ROW acquisition

See Handout



Tentative Project Schedule

Dependent on Federal Funding

Landowner Meetings	Early 2019
Final Design	2019
ROW Acquisition Process	2020 / 2021
Construction	2022





Estimated Cost:	\$17.9 million
-----------------	----------------

Final surfacing is planned for 2023

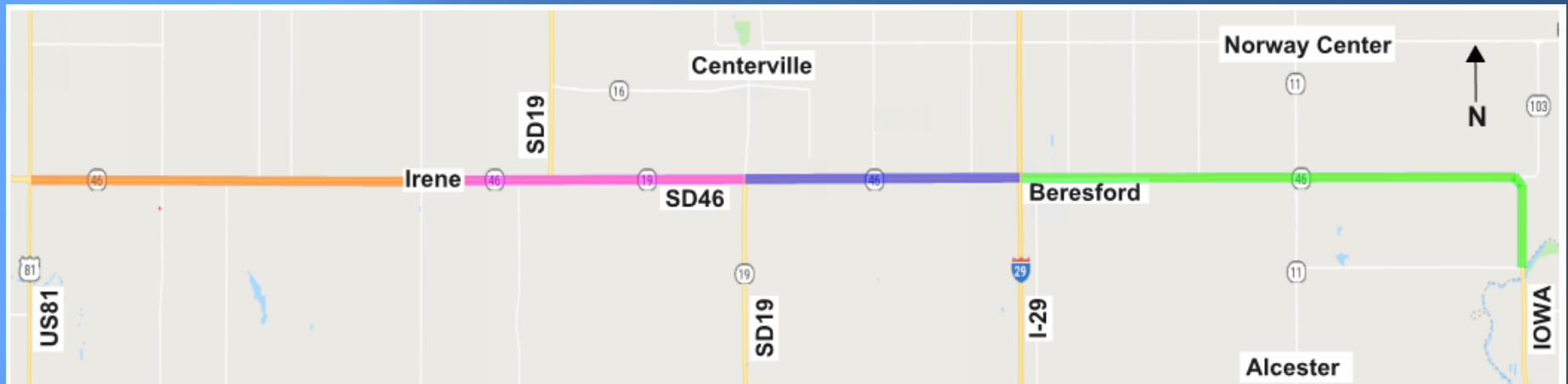

Projects in the Area



-  Shoulder Widening, Structures, Spot Grading, AC Mill & Overlay (2020 / 2021)
-  Shoulder Widening, Structures, Spot Grading, Full Depth Reclamation & AC Overlay (2020 / 2021)
-  Grading, Structures & Interim Surfacing (2022)
-  Grading, Structures & Interim Surfacing (2022)

Questions or Comments

Please Submit Questions or Comments by
November 14, 2018 to:

Cary Cleland

South Dakota Department of Transportation

5316 West 60th St. North

Sioux Falls, SD 57107

Cary.Cleland@state.sd.us

Public Meeting Information @

<http://sddot.com/dot/publicmeetings/default.aspx>

