

 CITY MAP
CANTON
 LINCOLN COUNTY - SOUTH DAKOTA
 T 98 N - R 49 W

SCALE
 0 1000 2000 ft.
 2021
 PREPARED BY
SOUTH DAKOTA
DEPARTMENT OF TRANSPORTATION
 U.S. DEPARTMENT OF TRANSPORTATION
 FEDERAL HIGHWAY ADMINISTRATION
 ALL DIMENSIONS SHOWN IN FEET
 UNLESS OTHERWISE SPECIFIED
 SUFFICIENT DIMENSIONS

LEGEND

U.S. NUMBERED HIGHWAY	
STATE NUMBERED HIGHWAY	
STREAM, CREEK, AND OTHER WATERWAYS	
CANALS, LATERALS, IRRIGATION DITCHES	
DIRT ROAD	
GRAVEL SURFACE	
EARTH SURFACE	
RAILROAD	
TRAIL	
CRACK	
CENTRAL BUSINESS DISTRICT	
TOWN CENTER (COUNTY SEAT)	
CITY LIMITS	
RAILROAD	
GRAIN ELEVATOR	
SANITARY POOL	
BALL FIELD	
CENTURY	
HOSPITAL	
MOBILE GARAGE (C-COUNTY, S-STATE)	
POST OFFICE	
CHURCH	
LIBRARY	
POWER PLANT	
WATER SUPPLY STAND PIPE OR TANK	
WATER TOWER	
WATER PLANT	
FARMHALL	
SCHOOLHOUSE	
TOWNHALL	
WATER	
POLICE STATION	
AIRPORT	

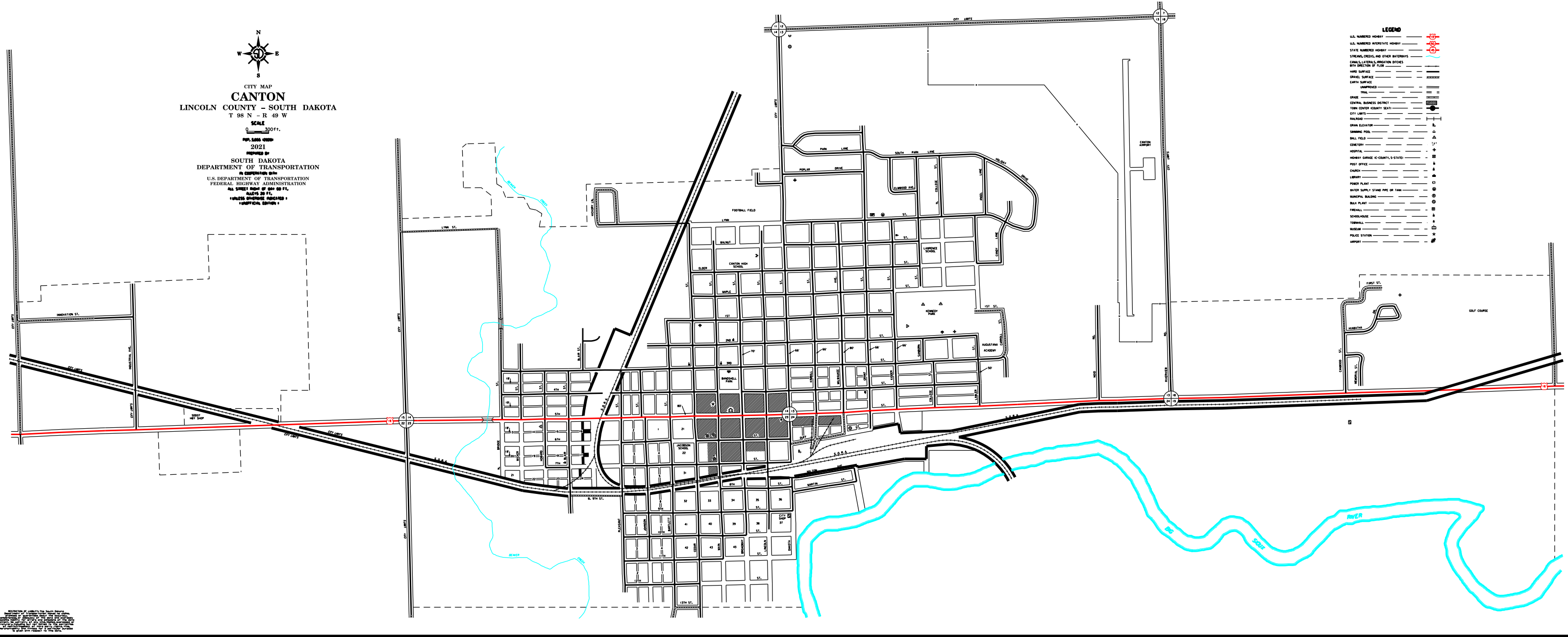

ALL DIMENSIONS SHOWN IN FEET UNLESS OTHERWISE SPECIFIED
 SUFFICIENT DIMENSIONS
 PREPARED BY SOUTH DAKOTA DEPARTMENT OF TRANSPORTATION
 U.S. DEPARTMENT OF TRANSPORTATION FEDERAL HIGHWAY ADMINISTRATION
 2021